

WCN2-0028SR-C11

SPECIFICATION

WCN			CUSTOMER
NOTE:			

REVISION: 01

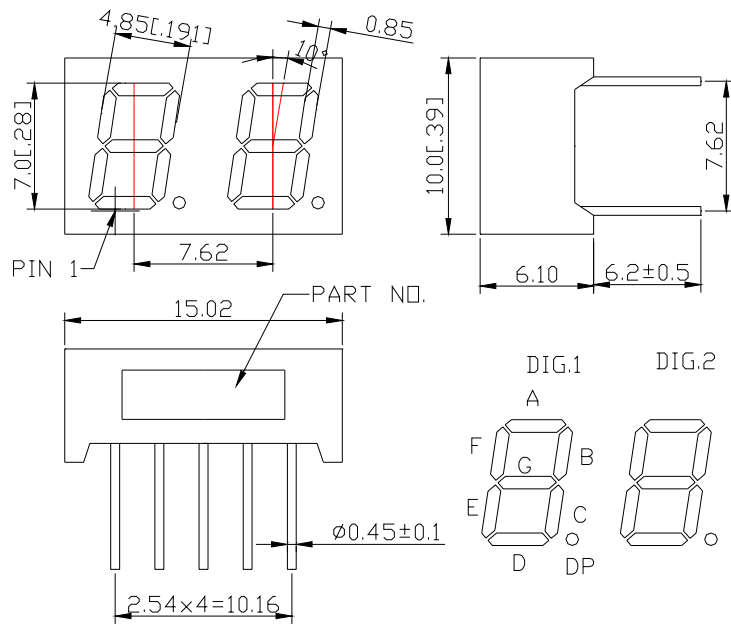

Notes: Unless otherwise stated, The tolerance is $\pm 0.25\text{mm}$.

■ Circuit Diagram:

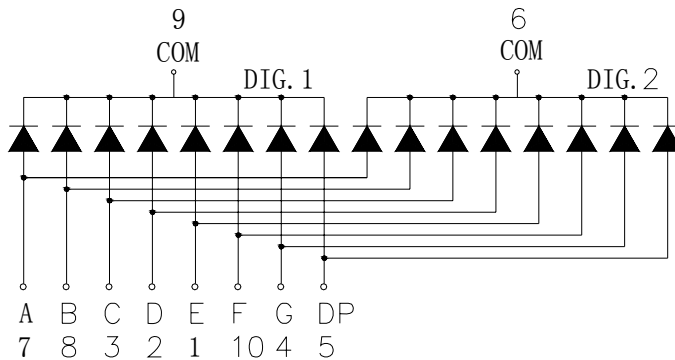

■ Pin Connection:

PIN NO.	CONNECTION	PIN NO.	CONNECTION
1	Anode E	6	Common Cathode
2	Anode D	7	Anode A
3	Anode C	8	Anode B
4	Anode G	9	Common Cathode
5	Anode DP	10	Anode F

■ Features:

- High Reliability
- Color: Red
- Low Power Requirement
- Easy Assembly

- Single Digit LED Display
- Digit Height:7.0mm(0.28")
- Black Face And Encapsulation With Milky Epoxy

■ Absolute Maximum Rating (Ta=25°C):

Parameter	Symbol	Condition	Color	Rating	Units
Power Dissipation Segment/DP	P _d	—	Red	50	mW
Forward Current Segment	I _F	—	Red	25	mA
Derating Of If Per Segment	ΔI _F	Ta ≥ 25°C	Red	0.4	mA/°C
Peak Forward Current Per Segment	I _{FP}	1/10 Duty 10KHz	Red	100	mA
Reverse Voltage Per Segment/DP	V _R	—	Red	5	V
Operating Temperature Range	Topr	—	—	-35~+85	°C
Storage Temperature Range	Tstg	—	—	-35~+85	°C

■ Electrical/Optical Characteristics Rating(Ta=25°C)

Item	Symbol	Test conditions	Location	Color	Rating			Units
					Min.	Typ.	Max.	
Forward Voltage	V _F	I _F =20mA	Per Segment	Red	—	1.8	2.0	V
Reverse Current	I _R	V _R =20V	Per Segment	Red	—	—	100	μA
		V _R =10V						
Luminous Intensity	I _V	I _F =10mA	Per Segment	Red	2.2	4.0	—	mcd
Wave Length	λ _P	I _F =20mA	Per Segment	Red	—	643	—	nm
	λ _D					660		
Spectral Line Half Width	Δλ	I _F =20mA	Per Segment	Red	—	20	—	nm
Luminous Intensity Matching Ratio (Segment to Segment)	I _{v-m}	I _F =10mA	—	—	—	—	2:1	

■ Notes: Luminous intensity tolerance : +/-10%

■ Soldering Conditions: Soldering Temp. ≤+260°C Soldering Time. ≤3sec.
(at 2mm Distance from The Case of Reflector Edge)